

**Troubleshooting Chart:**

Problem	Cause	Solution
1. System does not operate	a. No water b. Clogged water inlet strainer c. Primary float valve failure	a. Open water supply b. Disconnect inlet water line and clean strainer c. Clean* or replace with valve parts kit Drain overflow reservoir to resume operation
2. Floats are not turning water flow On/Off	a. Unit not level, float chain twisted	a. Make sure unit is level - float hangs level Make sure float chain is not twisted or obstructed
3. Solution strength too low	a. Low inlet pressure Inlet tube kinked	a. Adjust inlet pressure higher using regulator (Turn pressure adjustment screw clockwise to increase pressure) Make sure tubing is not kinked

Note: Colder water temperatures result in a decrease in the chemical dissolve rate.

\* Hard water may cause build-up of mineral deposits in water valve. Remove deposits by soaking the valve parts in a deliming solution.

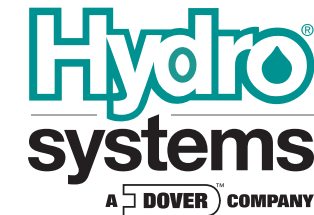

**592**

**Hi-Volume Solid Dissolver**

**Package Should Contain:**

1. Dissolver Board
2. Floats (2)
3. Solution Outlet Ball Valve
4. Mounting Kit
5. Instruction Manual

**THANK YOU FOR YOUR INTEREST IN OUR PRODUCTS**

Please use this equipment carefully and observe all warnings and cautions.

\*\*\*\*\* NOTE \*\*\*\*\*

<b>WEAR</b>	protective clothing and eyewear when dispensing chemicals or other materials or when working in the vicinity of all chemicals, filling or emptying equipment, or changing metering tips.
<b>ALWAYS</b>	observe safety and handling instructions of the chemical manufacturer. direct discharge away from you or other persons or into approved containers. install solid dissolver in an area with a floor drain nearby, and connect overflow port with hose to drain. dispense cleaners and chemicals in accordance with manufacturer's instructions. Exercise <b>CAUTION</b> when maintaining your equipment. reassemble equipment according to instruction procedures. Be sure all components are firmly screwed or latched into position.
<b>KEEP</b>	equipment clean to maintain proper operation.

**UNIT SPECIFICATIONS:**

- Weight: -- 30lb. Dry  
-- 50lb. With full chemical bottle and full solution reservoir
- Dimensions: -- 35" W X 27" H X 10" D
- Water inlet pressure: -- 25 psi. minimum  
-- 80 psi. maximum

**Installation and Operation:**

1. Drill holes for the four wall anchors with a (9/32") drill, using the mounting board as a template. Make sure the board is level.
2. Remove the doors on either side of the board to gain access to the internal components.
3. Install the 2 floats on the hooks inside the board.
4. Install the solution outlet ball valve into the threaded fitting on the bottom of the reservoir.
5. Connect water supply line to the water inlet ball valve push-in fitting.
6. Connect the outlet supply line to the solution outlet ball valve push-in fitting.
7. Place chemical bottles securely in solid bowl assemblies.
8. Turn on water supply valve. Adjust pressure regulator.
9. Open solution outlet ball valve.
10. The float valves will call for water to be sprayed into both of the solid bowls at the same time.



**SOLID DISSOLVER Parts Diagram and List:**

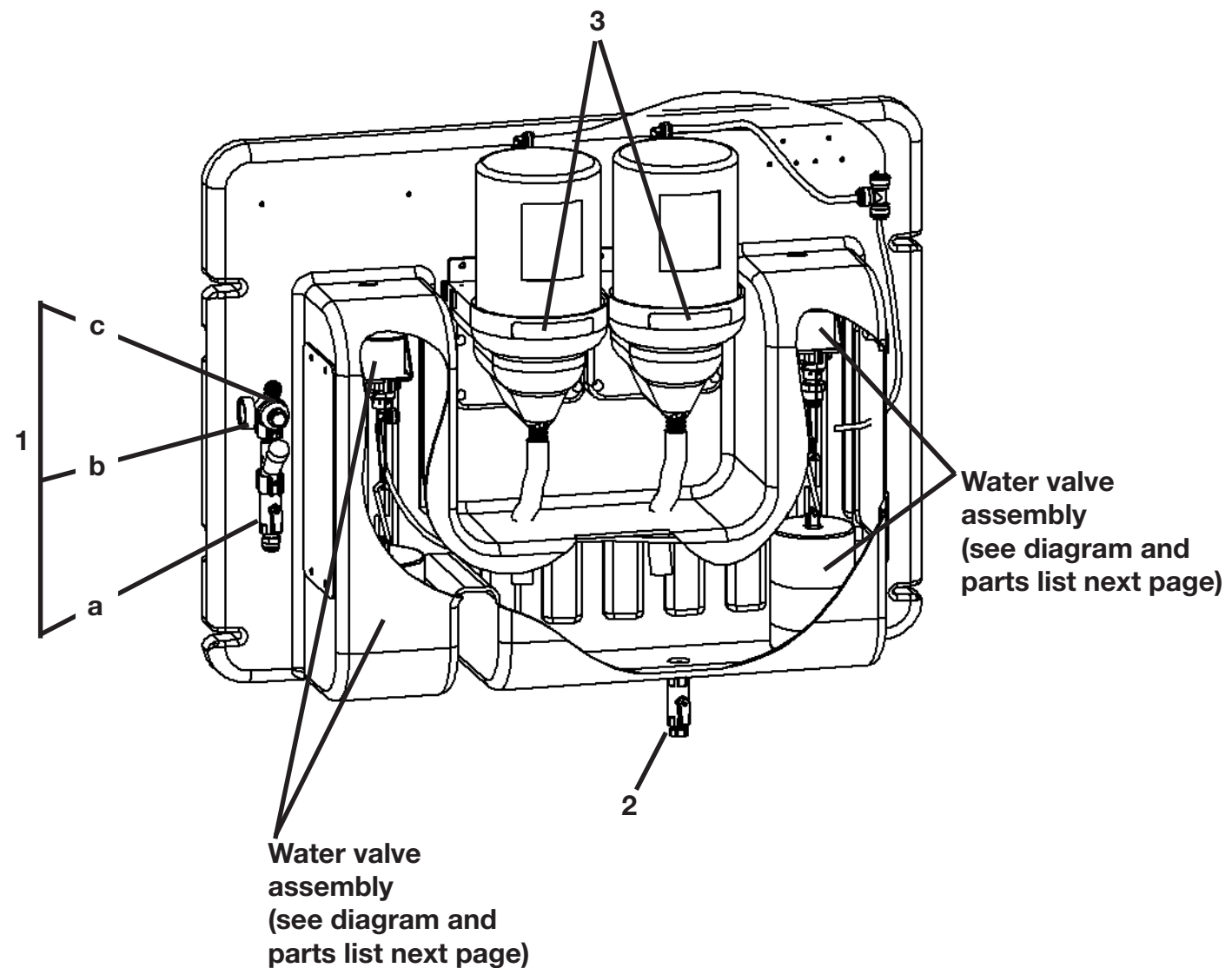

Key	Part No.	Description
1		Water inlet assembly
a	90085153	Water inlet ball valve
b	90085154	Strainer
c	90085155	Pressure regulator/gauge
2	90085153	Ball valve, solution outlet
3	90086212	Solid bowl assemblies

**Water Valve Parts Diagram and List:**

Key	Part No.	Description
1		magnet parts kit
		a. screw
		b. washer
		c. magnet cover
		d. magnet cap
		e. magnet
		f. magnet spring
		g. magnet yoke
		h. s-hook
2	10092551 665520	valve parts kit
		h. valve guide assembly
		i. armature spring
		j. armature
		k. diaphragm
3	520000	water valve body
4	5043-A	float

